

HGP Part Number	HorsePower (HP)	kVar	Harmonic	Voltage (V)	Hz.	Phase
HGP0040BW----	40	10	5th	240	60	3

Note: For Torque Information See IOM Manual.

Customer Connections.
L1, L2, L3, T1, T2, T3
Wire Range: 250MCM to 6AWG.

Ground Lug
Wire Range: 250MCM to 6AWG.

HGP Part Number	Schematic Drawing #	Approx Weight (LBS)
HGP0040BW0S0000	30209-S	220
HGP0040BW0C0000	30209	225
HGP0040BW0S1000	30209-PQ1	221
HGP0040BW0C1000	30209-PQ	226
HGP0040BW1S0000	30209-S	315
HGP0040BW1C0000	30209	320
HGP0040BW1S1000	30209-PQ1	316
HGP0040BW1C1000	30209-PQ	321

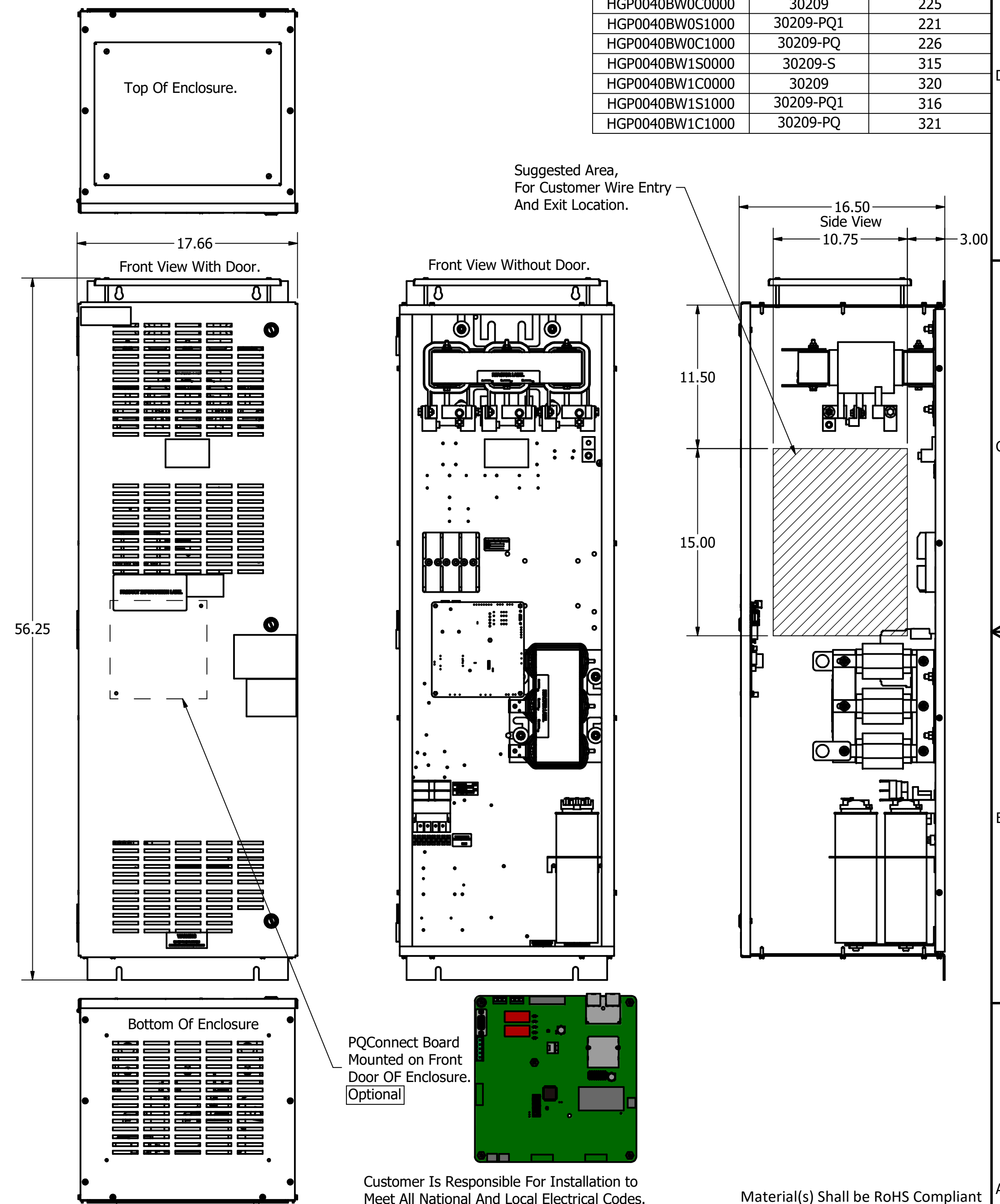
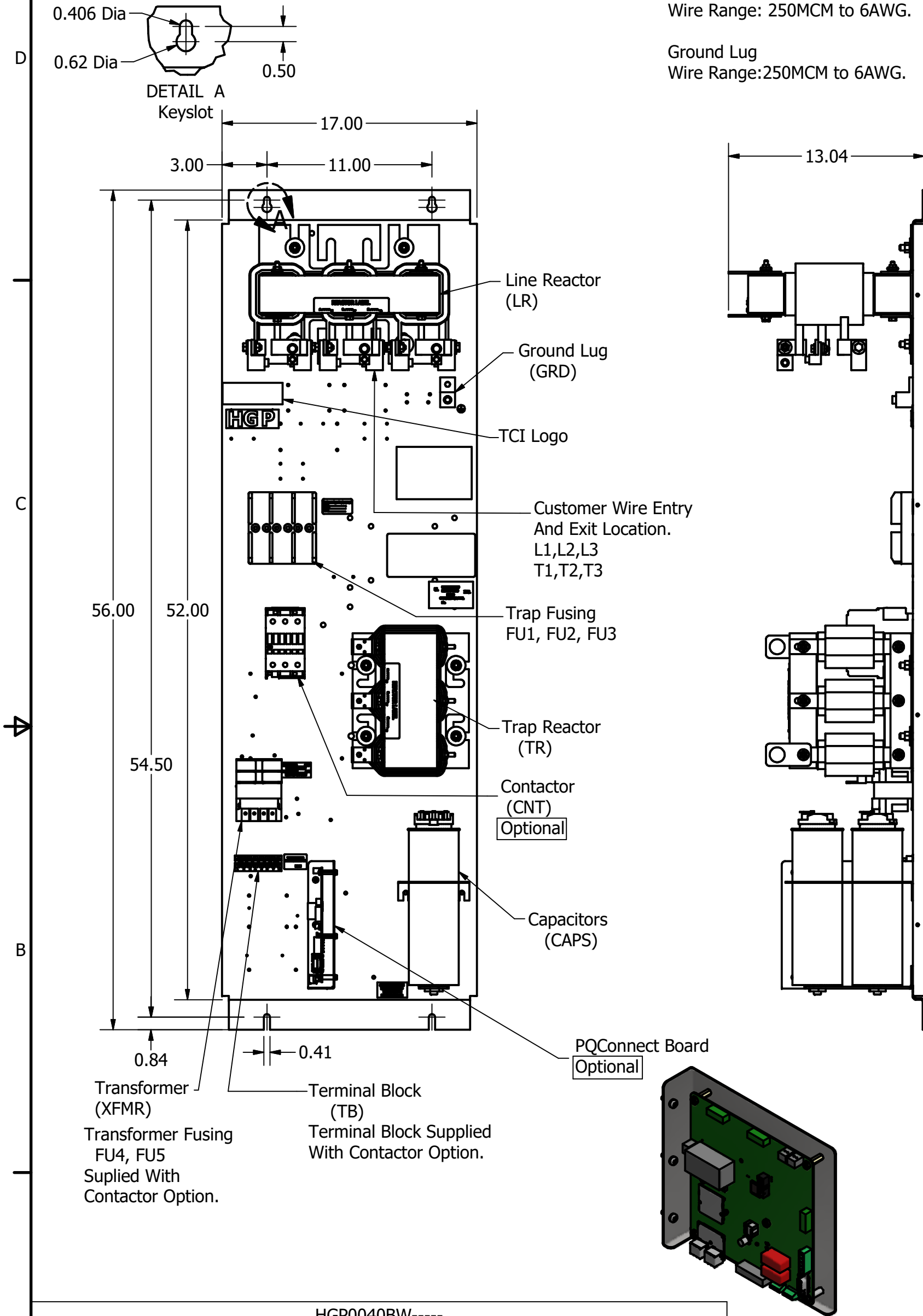

HGP0040BW----				
Components	0S0000/ 1S0000	0C0000/ 1C0000	0S1000/ 1S1000	0C1000/ 1C1000
Line Reactor (LR)	X	X	X	X
Trap Reactor (TR)	X	X	X	X
Capacitor (Cap)	X	X	X	X
Trap Fusing, FU1, FU2, FU3	X	X	X	X
Contactor (CNT)		X		X
Transformer (XFMR)		X	X	X
XFMR Fusing, FU4, FU5		X	X	X
PQConnect Board			X	X

Customer Is Responsible For Installation to Meet All National And Local Electrical Codes.

Material(s) Shall be RoHS Compliant

TCI, LLC CLAIMS PROPRIETARY RIGHTS IN THE MATERIAL HEREIN DISCLOSED. IT IS SUPPLIED WITHOUT PREJUDICE TO ANY PATENT RIGHTS OF TCI AND MAY NOT BE REPRODUCED OR USED TO MANUFACTURE ANYTHING SHOWN THEREIN WITHOUT WRITTEN PERMISSION FROM TCI.

TOLERANCES (EXCEPT AS NOTED)	
DECIMAL	FRACTIONAL
.XX ± .25	± 1/16
.XXX ± .10	ANGULAR ± 1°

W132 N10611 Grant Drive
Germantown, WI 53022

HarmonicGuard Passive
HGP, 40HP, 240/3/60, Open and Type 1

DRN BY: JRN	DATE: 08/03/18	107808DG
SCALE: 1/6	APRVD:	SIZE: C

NO REVISION DATE BY

SHT 1 OF 1